

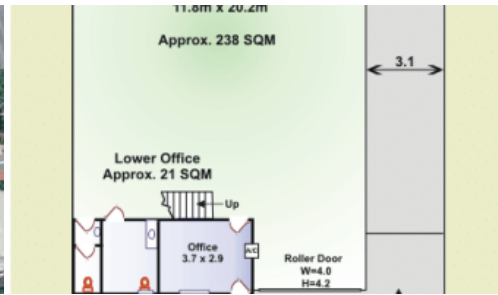

**10 Ware St, Thebarton**



## FOR LEASE

Features of the property include:

- Warehouse Space (Ex-Rock-climbing Gym)
- Suitable for Many Uses
- **Total Lettable Area of 280 sqm\* (approx.)**
- Main Road Exposure
- Large Roller Shutter Doors
- Amenities Onsite
- Ample Car Parking
- Flexible Terms and Conditions

INSPECTION IS A MUST

If you would like to inspect the property, please contact Jordan House on 0405 488 052, Pasquale Mastrangelo 0409 465 863 or our Landline on (08) 8212 0140.

*The above information provided has been furnished to us by the vendor/s. We have not verified whether or not that information is accurate and do not have any belief in one way or the other in its accuracy. We do not accept any responsibility to any person for its accuracy and do no more than pass it on. All interested parties should make and rely upon their own inquiries in order to determine whether or not this information is in fact accurate.*

**Price** CONTACT AGENT

**Property Type** Commercial

**Property ID** 2533

**Warehouse Area** 280 m2

### Agent Details

Pasquale Mastrangelo - 0409 465 863

MRE Office - 08 82120140

### Office Details

Adelaide

Unit 4/ 60 West Terrace, Adelaide  
SA 5000 Australia

08 8212 0140



MASTRACORP  
REAL ESTATE